



ORION

Alu-Tech Bodysell

Broaden your horizons



www.baileyorion.co.uk



Bailey Orion

Broaden your horizons

A vehicle designed to allow you to get the most from the great outdoors Orion offers you the flexibility of use as a mobile base from which to enjoy your chosen leisure activity.

It is built using the same high performance Alu-Tech construction system featured in the other Bailey ranges and it also includes a GRP outer skin for extra durability. This provides the vehicle with numerous benefits of ownership including a comprehensive manufacturer's warranty and an extended bodyshell integrity guarantee* for additional peace of mind.

The compact exterior disguises spacious interiors that include everything you will need for anything from a weekend break to an extended holiday. Orion also includes a number of luxuries, such as a microwave oven and a branded Radio/CD/MP3 player with stereo speakers, to ensure that you will be totally self-contained.

So if you have never considered a touring home before, why not broaden your horizons by looking at the Bailey Orion - a compact affordable vehicle that will be all the caravan you will ever need.

*Terms and conditions apply. Supplied with a 6 year bodyshell integrity guarantee and a 3 year manufacturers components warranty. 4 Year extension to bodyshell integrity guarantee available as a cost option (making 10 years in total). Please visit www.baileyorion.co.uk for more information on the Orion warranty package.

What makes Orion different?

- Lightweight design makes it towable by a wide range of vehicles
- Compact exteriors disguise spacious interiors which fit in much more than you think
- High performance Alu-Tech bodyshell to provide greater protection against the elements
- AL-KO chassis and safety equipment to give you added peace of mind when on your travels
- Added luxuries such as a branded Radio/CD/MP3 player and a microwave oven as standard specification



www.baileyorion.co.uk



Orion 430-4 (Bed linen available as a cost option)



Orion 400-2

Key Specification Features

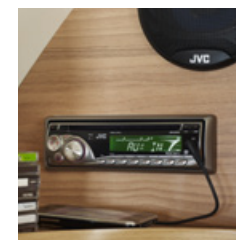
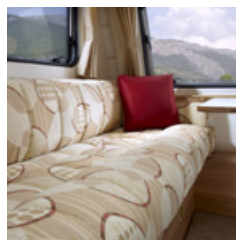
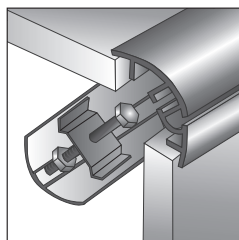

CONSTRUCTION

Alu-Tech fully laminated five part body shelf assembly (Panel thickness of: sides 37mm, ceiling 37mm & floor 44mm) housed in a structural interlocking aluminium framework • Supplied with a 6 year bodyshell integrity guarantee and a 3 year manufacturers components warranty. 4 Year extension to bodyshell integrity guarantee available as a cost option (making 10 years in total)* • EN-1645 Grade III classification for heating and thermal insulation (Cold chamber tested)

SAFETY & SECURITY

AL-KO chassis mounted spare wheel carrier and spare wheel (steel spare wheel) • AL-KO AKS 3004 stabiliser • Optional AL-KO secure wheel lock

EXTERIOR FEATURES

AL-KO galvanised steel chassis, axle, braking system and running gear • 14" Alloy wheels with bespoke caravan tyres • Large aperture two part Hartal exterior door • Polycrystalline double glazed windows through out • Retractable flyscreens and blinds to all windows and roof lights • Dedicated gas bottle, battery and toilet cassette compartments with exterior access doors • Status 550 directional television aerial • Midi Heki

rooflight located over front saloon • Mini Heki roof light located over rear bedroom (model specific)

INTERIOR FEATURES

Furniture & Soft Furnishings

Italian design caravan furniture in Bailey 'walnut' finish • Standard 'Unity' soft furnishings with co-ordinating curtains plus two bolster cushions and two scatter cushions • Fully sprung upholstery (except split cushions in bunk make-up) featuring premium quality fabrics, high density filling and superior cushion construction and a De-Luxe sprung double bed mattress (model specific) • Split section loose fit drop in carpets

Services

Truma Ultrastore water heater (gas/electric operation) • Whale Aqua Smart II on-board water pump • Whale floor mounted space heater and blown air heating system • Inboard pressurised hot and cold fresh water system with reinforced hosing • 230v power supply with two interior sockets • TV station with 230v, 12v and aerial sockets • 12v internal spotlights • 12v ceiling lights • Additional LED pelmet lights above central kitchen

Kitchen Equipment

Thetford 107 litre refrigerator with full width freezer • Thetford Duplex combination oven and grill • Thetford

3-burner gas hob incorporating flush fitting glass hinged lid and conveniently located controls • Thetford kitchen sink with removable draining board, chopping board and mixer tap • Stainless steel 800 watt microwave oven conveniently located at eye level

Washroom Equipment

Thetford C-260 cassette toilet • 'Belfast' style washroom sink and mixer tap • Inboard shower unit and mixer tap

Entertainment

Branded Radio/CD/MP3 player with iPod connectivity • Branded stereo speakers for superior sound quality

**Terms and conditions apply. Full specification and warranty information details can be found by visiting the Orion product micro site www.baileyorion.co.uk*



Model Range & Technical Specifications

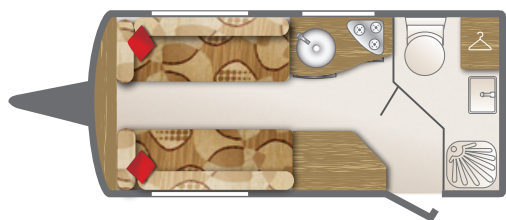

400-2 2 Berth



430-4 4 Berth



440-4 4 Berth

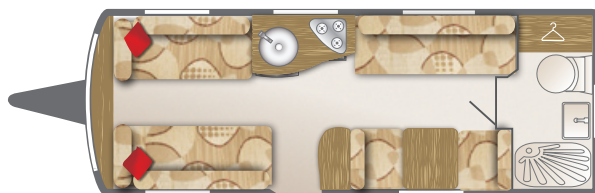

460-5 5 Berth

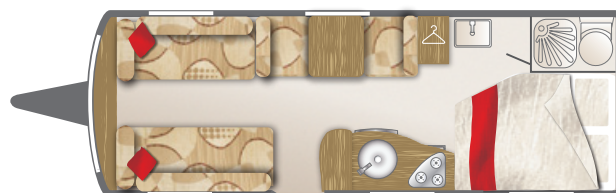

530-6 6 Berth

	400-2	430-4	440-4	460-5	530-6
Berths	2	4	4	5	6
Internal Length	4.184m / 13'9"	5.225m / 17'2"	5.225m / 17'2"	5.345m / 17'6"	5.678m / 18'8"
Shipping Length	5.347m / 17'7"	6.388m / 20'11"	6.388m / 20'11"	6.508m / 21'4"	6.841m / 22'5"
Overall Width	2.19m / 7'2"	2.19m / 7'2"	2.19m / 7'2"	2.19m / 7'2"	2.19m / 7'2"
Overall Height	2.63m / 8'8"	2.63m / 8'8"	2.63m / 8'8"	2.63m / 8'8"	2.63m / 8'8"
Internal Headroom	1.96m / 6'5"	1.96m / 6'5"	1.96m / 6'5"	1.96m / 6'5"	1.96m / 6'5"
Awning Size	825cm	929cm	929cm	941cm	974cm
Tyre Sizes	195/70 R14 LI96N	195/70 R14 LI96N	195/70 R14 LI96N	185/ R14 LI104N	185/ R14 LI104N
MTPLM	1076kg / 21.2cwt	1247kg / 24.5cwt	1249kg / 24.6cwt	1345kg / 26.5cwt	1380kg / 27.2cwt
MRO	959kg / 18.9cwt	1100kg / 21.7cwt	1102kg / 21.7cwt	1181kg / 23.2cwt	1205kg / 23.7cwt
Optional Equipment Payload Allowance	3kg / 0.1cwt	3kg / 0.1cwt	3kg / 0.1cwt	3kg / 0.1cwt	3kg / 0.1cwt
Total User Payload	117kg / 2.3cwt	147kg / 2.9cwt	147kg / 2.9cwt	164kg / 3.2cwt	175kg / 3.4cwt
Front Double	6'1" x 6'6"	4'8" x 6'6"	4'8" x 6'6"	5'0" x 6'6"	4'10" x 6'6"
Front N/S Single	6'1" x 2'3"	4'8" x 2'3"	4'8" x 2'3"	5'0" x 2'3"	4'10" x 2'3"
Front O/S Single	6'1" x 2'3"	5'0" x 2'3"	5'0" x 2'3"	5'0" x 2'3"	5'0" x 2'3"
N/S Single	-	-	-	6'3" x 2'3"	-
O/S Single	-	-	-	6'0" x 2'3"	5'7" x 2'3"
O/S Overhead Single	-	-	-	5'6" x 2'0"	5'5" x 2'0"
Rear Double	-	-	6'4" x 4'6"	-	-
Rear Fixed Double	-	6'4" x 4'6"	-	-	6'4" x 4'6"

The method of calculating the MRO and payload figures has been changed for the 2011 model year. Allowances for essential equipment previously accounted for in the user payload are now either within the MRO (e.g. gas cylinders) or the personal effects payload allowance (e.g. leisure battery).



AL-KO Chassis mounted spare wheel carrier and spare wheel



Centrally mounted gas bottle locker



Thetford 3-burner gas hob



Stainless steel 800 watt microwave oven



Thetford 107 litre refrigerator with full width freezer compartment

360 degree product tours for all layouts can be viewed on the Orion microsite: www.baileyorion.co.uk



Orion 530-6 (Television not included as standard specification)



Orion 440-4



Orion 460-5



www.baileyofbristol.co.uk

South Liberty Lane, Bristol BS3 2SS, England

This brochure does not constitute an offer by Bailey Caravans Ltd (Bailey). Bailey reserves the right to alter specifications and prices as market and supply conditions demand. Your Bailey retailer will confirm all specification details prior to you making your purchasing decision. E. & O. E. Bailey retailers sell our products of their own choice and not as agents of Bailey. Accordingly they have no authority to bind Bailey or to make any representation or undertaking whatsoever on behalf of Bailey. All household items illustrated in this brochure are used to enhance photography and are for display purposes only. They are not supplied with your touring caravan. Photographic colour reproduction is subject to the limitations of the production process.

Design & Print: Kingsdown Photography: Alan Bond Issued: February 2013



80% Recycled paper



NATIONAL CARAVAN
COUNCIL LIMITED

All Bailey models have been certified by the National Caravan Council for compliance with stringent European Standards, British Legislation and industry set Codes of Practice specifically relating to health and safety issues. NCC Approval gives you peace of mind that your caravan is safe and legal

ORION
Alu-Tech Bodysell

Broaden your horizons



Orion 460-5