



UNICORN  
Alu-Tech Bodysell

*Seeing things in a different light*



[www.baileyofbristol.co.uk](http://www.baileyofbristol.co.uk)





# Bailey Unicorn

*Seeing things in a different light*

A firm favourite with the discerning caravan owner, Unicorn sets the standard for a premium product range by providing the very best in touring caravan design.

All models feature the Alu-Tech bodyshell, which is cloaked in a GRP outer skin, to provide the vehicle with numerous benefits of ownership including a comprehensive manufacturer's warranty and an extended bodyshell integrity guarantee\* giving you long term peace of mind.

Inside the caravan is totally transformed with the introduction of a new vertical front skylight to create the perfect room with a view, while feature kitchens and washrooms offer both style and practicality to give the new Unicorn the all important wow factor.

As practical as they are comfortable these well thought-out caravans include a host of new features designed to make your life easier. Ranging from a fully specified Alde central heating system, a Thetford Caprice combination oven, grill and new dual-fuel hob featuring an electric hotplate to the freestanding home entertainment system incorporating a new 18.5" flat screen television and DVD player everything has been thought of to make these models a pleasure to own.

Considerably lighter than its predecessor and supplied with a surprisingly competitive retail price the new Bailey Unicorn is a vehicle without compromise and one which puts ownership of a premium caravan within reach of many more people for the first time.



*\*Terms and conditions apply. Supplied with a 6 year transferable bodysell integrity guarantee and a 3 transferable year manufacturers components warranty. 4 Year transferable extension to bodysell integrity guarantee available as a cost option (making 10 years in total). Please visit [www.baileyofbristol.co.uk](http://www.baileyofbristol.co.uk) for more information on the Unicorn warranty package.*



## What makes Unicorn different?

- The UK's most popular premium caravan range in a choice of eight best selling layouts suitable for both couples and small families
- A high performance Alu-Tech bodysell with a GRP outer skin to provide greater protection against the elements
- A fully specified Alde central heating system which combines with market leading bodysell thermal performance to make Unicorn the ultimate 4-season vehicle
- A market-leading safety & security package with the AL-KO ATC Trailer Control System, Michelin branded tyres and a TRACKER Monitor Stolen Vehicle Recovery System all supplied as standard
- Light and spacious interiors created with unique design features such as an opening vertical skylight and recessed front chest for superior levels of comfort





Unicorn Seville (Optional Rossini upholstery shown)





Unicorn Valencia (Standard Mozart upholstery and optional bed linen shown)



# Key Specification Features

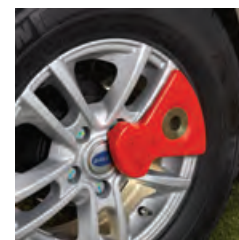
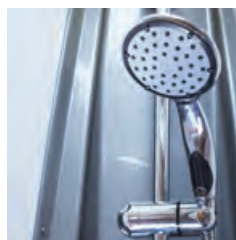
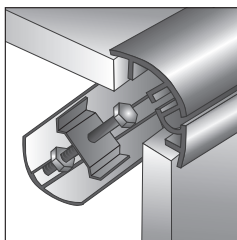

## ALU-TECH BODY SHELL

Structural interlocking aluminium extrusion external framework with no external fixing points and concealed awning channels on both sides • Five part fully bonded exterior panel assembly system • NEW upper body panels cloaked in a single sheet impact resistant GRP outer skin for extra durability • NEW one piece integrated front and rear impact resistant bumpers • NEW design step up a-frame fairing • Supplied with a 6-year transferable bodyshell integrity guarantee and a 3-year transferable manufacturers components warranty\* • 4-year transferable extension to bodyshell integrity guarantee available as a cost option (making 10 years in total)\* • EN-1645 Grade III classification for heating and thermal insulation (cold chamber tested) • European Whole Vehicle Type Approved

## EXTERIOR FEATURES

AL-KO galvanised steel chassis, braking system and running gear • NEW style 14" alloy wheels with Michelin branded tyres • Hartal two part large aperture exterior door with window, blind and waste bin • NEW Double glazed Polyplastic opening vertical skylight in front dome • Double glazed Polyplastic opening windows throughout • Midi and Mini Heki rooflights located throughout main habitation area • NEW centrally mounted easy-access gas locker for enhanced stability and reduced nose weight • Exterior 230v socket & gas BBQ point • NEW Status 550 telescopic directional television aerial • NEW exterior aerial point for portable satellite dish connection • NEW exterior solar panel connection provision • NEW design graphics scheme

## INTERIOR FEATURES

### Furniture & Soft Furnishings

Bailey "Walnut" furniture finish • NEW construction front bed boxes with slide out double bed make up • NEW sprung beech bed box tops for additional comfort • NEW drop down flaps on front bed box fascias • Large front window shelf • NEW recessed 3-drawer front chest with slide out occasional table • Seat and

backrest ventilation boards • NEW light-weight free standing table with dedicated storage • NEW aircraft style overhead locker system with split level storage, domestic style metal hinges and brushed steel handles • NEW dual finish Italian design overhead locker doors • NEW contrasting kitchen overhead locker system with feature drinks cabinet • NEW Bailey "Walnut" finish skylight mounting with integral ambient and task lighting • NEW ergonomic dual-level kitchen units with integral storage • NEW solid domestic style washroom door with metal handle • NEW granite finish kitchen and washroom worktop laminate • Premium quality fixtures and fittings in brushed steel finish • NEW design fixed double beds with aluminium frames and gas strut assisted opening mechanism • Fully sprung upholstery (except split cushions used in bunk make-up) featuring premium quality fabrics, high density filling and superior cushion construction and a De-Luxe sprung mattress (model specific) • NEW Standard Mozart soft furnishings with co-ordinating curtains, arm rests and four large scatter cushions • NEW Optional Rossini soft furnishings with co-ordinating curtains, arm rests and four large scatter cushions • Deep pile loose fit drop in carpets (45 oz pile weight)

## SERVICES

### Electrical System

NEW 230v power supply with up to six interior sockets • TV station with 230v, 12v and a minimum of two aerial sockets • NEW 12v ambient and task lighting in vertical skylight surround • NEW 12v shower cubicle lighting • NEW centrally located digital electrical control panel

### Water & Gas System

Alde Hydronic Compact 3010 programmable radiator heating system with combined water heating • Alde heated towel rail • NEW stainless steel circular kitchen sink with swan-neck mixer tap, washing up bowl, drainer and chopping board • Thetford C-260 cassette toilet with integrated header tank • NEW inboard shower unit with ceramic ball mixer tap and Ecocamel shower head • NEW domestic style circular shower cubicle with curved partition door and integral

storage pod • NEW washroom hand basin with swan-neck mixer tap

### Kitchen Equipment

NEW Dometic 103 litre refrigerator with electronic ignition and detachable full width freezer compartment - capacity increases to 110 litres when freezer compartment is removed (model specific) • Dometic 190 litre fridge and freezer with electronic ignition (model specific) • NEW Thetford Caprice combined oven, grill and hob with electronic ignition and flame failure device • NEW dual-fuel hob with electric hotplate and 3 gas burners • Stainless steel 800 watt microwave oven

## GENERAL EQUIPMENT

NEW Remis pleated flyscreen and blinds to principal windows • NEW Remis 2-part pleated flyscreen and blind to vertical skylight • NEW Remis flyscreen and splash proof roller blind for kitchen and washroom windows • Hartal pleated full length flyscreen to exterior door • NEW branded combination home entertainment system featuring a 18.5" flat screen television and DVD player • Branded Radio/CD/MP3 player with iPod/MP3 player connection point • Branded dual cone stereo speakers for superior sound quality

## SAFETY & SECURITY

NEW wind down floor mounted spare wheel carrier and spare wheel (steel spare wheel) • AL-KO ATC Trailer Control System • AL-KO AKS 3004 Stabiliser • AL-KO shock absorbers • NEW alloy wheel security locking nuts • AL-KO caravan jack • AL-KO Secure portable wheel lock (two for twin axle models) • NEW caravan mud flaps • TRACKER intruder alarm • TRACKER Monitor Thatcham approved Stolen Vehicle Recovery System (including first 12 months subscription fee) • NEW high security entrance door lock

*\*Terms and conditions apply. Full specification and warranty information details can be found by visiting: [www.baileyofbristol.co.uk](http://www.baileyofbristol.co.uk)*

# Model Range & Technical Specifications

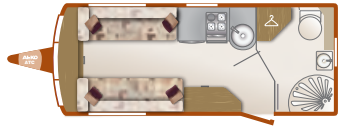

**Seville 2 Berth**



**Madrid 4 Berth**

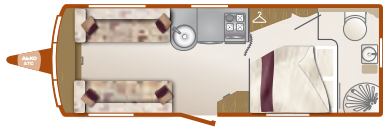

**Valencia 4 Berth**



**Vigo 4 Berth**

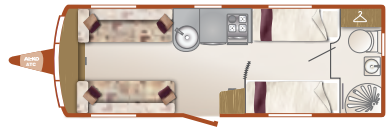

**Cadiz 4 Berth**



**Barcelona 4 Berth  
Twin-Axle**



**Cartagena 4 Berth  
Twin-Axle**



**Cordoba 4 Berth  
Twin-Axle**

	Seville	Madrid	Valencia	Vigo	Cadiz	Barcelona Twin-Axle	Cartagena Twin-Axle	Cordoba Twin-Axle
Berths	2	4	4	4	4	4	4	4
Internal Length	4.765m / 15'8"	5.438m / 17'10"	5.682m / 18'8"	5.682m / 18'8"	5.682m / 18'8"	6.232m / 20'5"	6.232m / 20'5"	6.232m / 20'5"
Shipping Length	6.424m / 21'1"	7.097m / 23'3"	7.341m / 24'1"	7.341m / 24'1"	7.341m / 24'1"	7.891m / 25'11"	7.891m / 25'11"	7.891m / 25'11"
Overall Width	2.28m / 7'6"	2.28m / 7'6"	2.28m / 7'6"	2.28m / 7'6"	2.28m / 7'6"	2.28m / 7'6"	2.28m / 7'6"	2.28m / 7'6"
Overall Height	2.61m / 8'7"	2.61m / 8'7"	2.61m / 8'7"	2.61m / 8'7"	2.61m / 8'7"	2.61m / 8'7"	2.61m / 8'7"	2.61m / 8'7"
Internal Headroom	1.96m / 6'5"	1.96m / 6'5"	1.96m / 6'5"	1.96m / 6'5"	1.96m / 6'5"	1.96m / 6'5"	1.96m / 6'5"	1.96m / 6'5"
Awning Size	953cm	1020cm	1045cm	1045cm	1045cm	1093cm	1093cm	1093cm
Tyre Sizes	185/R14 LI102R	185/R14 LI102R	185/R14 LI102R	185/R14 LI102R	185/R14 LI102R	185/65 R14 LI86T	185/65 R14 LI86T	185/65 R14 LI86T
MTPLM	1350kg / 26.6cwt	1484kg / 29.2cwt	1497kg / 29.5cwt	1498kg / 29.5cwt	1498kg / 29.5cwt	1686kg / 33.2cwt	1679kg / 33.0cwt	1657kg / 32.6cwt
MRO	1225kg / 24.1cwt	1329kg / 26.2cwt	1343kg / 26.4cwt	1344kg / 26.5cwt	1344kg / 26.5cwt	1526kg / 30.0cwt	1519kg / 29.9cwt	1497kg / 29.5cwt
Optional Equipment Payload Allowance	3kg / 0.1cwt	3kg / 0.1cwt	3kg / 0.1cwt	3kg / 0.1cwt	3kg / 0.1cwt	3kg / 0.1cwt	3kg / 0.1cwt	3kg / 0.1cwt
Total User Payload	125kg / 2.5cwt	155kg / 3.1cwt	154kg / 3.0cwt	154kg / 3.0cwt	154kg / 3.0cwt	160kg / 3.1cwt	160kg / 3.1cwt	160kg / 3.1cwt
Front Double	6'9" x 5'7"	6'9" x 5'6"	6'9" x 4'8"	6'8" x 4'2"	6'9" x 4'8"	6'9" x 5'3"	6'9" x 5'3"	6'9" x 5'4"
Front N/S Single	6'6" x 2'4"	6'1" x 2'4"	5'9" x 2'4"	4'9" x 2'4"	5'5" x 2'4"	5'9" x 2'4"	5'9" x 2'4"	5'8" x 2'4"
Front O/S Single	6'2" x 2'4"	6'1" x 2'4"	5'2" x 2'4"	4'6" x 2'4"	5'2" x 2'4"	6'2" x 2'4"	5'9" x 2'4"	6'1" x 2'4"
O/S Single	-	6'3" x 1'11"	-	-	-	-	-	-
O/S Overhead Single	-	6'3" x 1'10"	-	-	-	-	-	-
N/S Rear Fixed Single	-	-	-	-	6'5" x 2'2"	-	-	6'3" x 2'2"
O/S Rear Fixed Single	-	-	-	-	6'0" x 2'2"	-	-	6'2" x 2'2"
Rear Fixed Double	-	-	6'3" x 4'4"	6'0" x 4'6"	-	6'3" x 4'4"	6'0" x 4'6"	-

A tolerance in the MRO has been allowed for in the calculations of Payload Margins. The awning length measurement shown is to be interpreted as a guide only and an enquiry should be made to individual awning manufacturers as to the correct size.



Branded home entertainment system featuring a 18.5" flat screen television and DVD player



Alde central heating system



Dual-fuel hob with electric hotplate and 3 gas burners



Dedicated drinks cabinet



Recessed 3 drawer front chest with slide out occasional table



Overhead locker system



360 degree product tours for all layouts can be viewed at: [www.baileyofbristol.co.uk](http://www.baileyofbristol.co.uk). To compare Unicorn models with those in our other ranges visit the 'Choose your Vehicle' section on the same website.



**UNICORN**

Alu-Tech Bodyshell

[www.baileyofbristol.co.uk](http://www.baileyofbristol.co.uk)



*Unicorn Cadiz (Optional Rossini upholstery and bed linen shown)*



*Unicorn Seville*



*Unicorn kitchen storage*



*Unicorn Barcelona (Standard Mozart upholstery shown)*





**www.baileyofbristol.co.uk**

South Liberty Lane, Bristol BS3 2SS, England



This brochure does not constitute an offer by Bailey Caravans Ltd (Bailey). Bailey reserves the right to alter specifications and prices as market and supply conditions demand. Your Bailey retailer will confirm all specification details prior to you making your purchasing decision. E. & O. E. Bailey retailers sell our products of their own choice and not as agents of Bailey. Accordingly they have no authority to bind Bailey or to make any representation or undertaking whatsoever on behalf of Bailey. All household items illustrated in this brochure are used to enhance photography and are for display purposes only. They are not supplied with your touring caravan. Photographic colour reproduction is subject to the limitations of the production process.

Design & Print: Kingsdown Photography: Alan Bond Issued: January 2014



80% Recycled paper



NATIONAL CARAVAN  
COUNCIL LIMITED



All Bailey models have been certified by the National Caravan Council for compliance with stringent European Standards, British Legislation and industry set Codes of Practice specifically relating to health and safety issues. NCC Approval gives you peace of mind that your caravan is safe and legal



*Seeing things in a different light*



Unicorn Madrid (Standard Mozart upholstery shown)