



**Olympus**  
Alu-Tech Bodyshell

*Lightening the load*



[www.baileyolympus-s2.co.uk](http://www.baileyolympus-s2.co.uk)



# Bailey Olympus

## *Lightening the load*

Bailey of Bristol has a proven track record of bringing well designed, well equipped, yet affordable vehicles to the market and in the process make the enjoyment of a touring caravan holiday available to a wider audience. None of our products typify this better than the new Olympus range.

All models feature the Alu-Tech bodyshell providing the vehicle with numerous benefits of ownership including a comprehensive manufacturer's warranty and an extended bodyshell integrity guarantee\* to provide you with long term peace of mind.

Interiors are enhanced with the introduction of new 'walnut' wood finish furniture, upgraded 12 volt lighting systems and the contemporary 'Panama' soft furnishings scheme giving the Olympus range fresh appeal. Specifications also remain exceptionally high for a tourer in this price bracket, with a large capacity Thetford refrigerator, an 800 watt stainless steel microwave oven and a branded Radio/CD/MP3 player with iPod connectivity all included as standard.

Surprisingly light for vehicles with this much interior space the new Olympus is well-suited to a wide range of tow vehicles, and with a competitive recommended retail price it becomes a viable alternative for a large number of potential new caravan owners.

All of which makes the new Olympus a very special caravan - light on its feet, light on your pocket, yet heavy on value.

\*Terms and conditions apply. Supplied with a 6 year bodyshell integrity guarantee and a 3 year manufacturers components warranty. 4 Year extension to bodyshell integrity guarantee available as a cost option (making 10 years in total). Please visit [www.baileyolympus.co.uk](http://www.baileyolympus.co.uk) for more information on the Olympus warranty package.

## What makes **Olympus** different?

- Lightweight family friendly layouts which can accommodate up to six people in complete comfort
- High performance Alu-Tech bodyshell to provide greater protection against the elements
- AL-KO ATC Trailer Control System fitted as standard for an enhanced towing experience
- Specification includes everything you will need for a relaxing and enjoyable holiday



[www.baileyolympus-s2.co.uk](http://www.baileyolympus-s2.co.uk)



Olympus 620-6 (Bed linen available as a cost option)



Olympus 460-2



# Key Specification Features

**Olympus**  
Alu-Tech Bodyshell

[www.baileyolympus-s2.co.uk](http://www.baileyolympus-s2.co.uk)

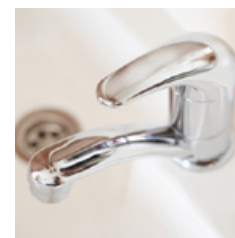
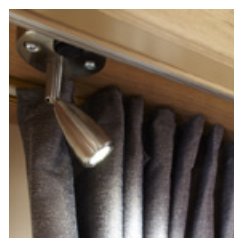
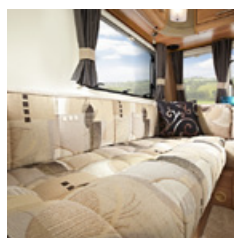
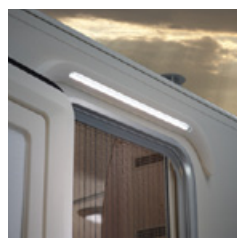
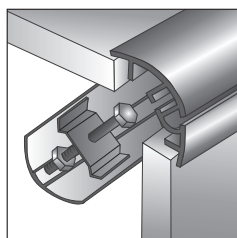

## CONSTRUCTION

Alu-Tech fully laminated five part body shell assembly (Panel thickness of: sides 37mm, ceiling 37mm & floor 44mm) housed in a structural interlocking aluminium framework • Supplied with a 6 year bodyshell integrity guarantee and a 3 year manufacturers components warranty. 4 Year extension to bodyshell integrity guarantee available as a cost option (making 10 years in total)\* • EN-1645 Grade III classification for heating and thermal insulation (Cold chamber tested)

## SAFETY & SECURITY

AL-KO chassis mounted spare wheel carrier and spare wheel (steel spare wheel) • AL-KO ATC Trailer Control System • AL-KO AKS 3004 stabiliser • AL-KO shock absorbers • Optional AL-KO secure wheel lock

## EXTERIOR FEATURES

AL-KO galvanised steel chassis, axle, braking system and running gear • 14" Alloy wheels with bespoke caravan tyres • Large aperture two part Hartal exterior door • Full length Horrex pleated door flyscreen • Polyclassic double glazed windows throughout • Retractable flyscreens and blinds to all front windows and roof lights • Dedicated gas bottle, battery and toilet cassette

compartments with exterior access doors • Status 550 directional television aerial • Full size Heki II rooflight located over front saloon • Mini Heki rooflight located over kitchen area • Midi Heki roof light located over rear bedroom (model specific)

## INTERIOR FEATURES

### Furniture & Soft Furnishings

Italian design caravan furniture in Bailey 'walnut' finish • Standard 'Panama' soft furnishings with co-ordinating curtains with two bolster cushions and two scatter cushions in a wrap-around configuration • Fully sprung upholstery (except split cushions in bunk make-up) featuring premium quality fabrics, high density filling and superior cushion construction and a De-Luxe sprung double bed mattress (model specific) • Split section loose fit drop in carpets • Optional chest of drawer unit with new design slide out occasional table

### Services

Truma 3004 3kw gas heater and supplementary 230v Ultraheat system with silent running night setting • Truma Ultratherm and blown air distribution system • Truma Ultrastore water heater (gas/electric operation) • Whale premium pump (submersible) • Optional wheeled fresh water container with dedicated storage (capacity

23 litres) • Inboard pressurised hot and cold fresh water system with reinforced hosing • 230v power supply with up to four interior sockets • TV station with 230v, 12v and aerial sockets • 12v internal spotlights • Flush fit 12v locker corner lights • 12v ceiling lights • Additional LED pelmet lights above central kitchen

### Kitchen Equipment

Thetford 107 litre refrigerator with full width freezer • Thetford recessed 4-burner hob unit incorporating flush fitting glass hinged lid and conveniently located controls • Thetford combined grill and domestic style glass fronted oven with electronic ignition and flame failure device • Thetford large capacity recessed sink with removable draining board, chopping board and mixer tap • Stainless steel 800 watt microwave oven conveniently located at eye level

### Washroom Equipment

Thetford C-260 cassette toilet • 'Belfast' style washroom sink and mixer tap • Inboard shower unit and mixer tap

### Entertainment

Branded Radio/CD/MP3 player with iPod connectivity • Branded dual cone stereo speakers for superior sound quality

*\*Terms and conditions apply. Full specification and warranty information details can be found by visiting the Olympus product micro site [www.baileyolympus-s2.co.uk](http://www.baileyolympus-s2.co.uk)*

# Model Range & Technical Specifications

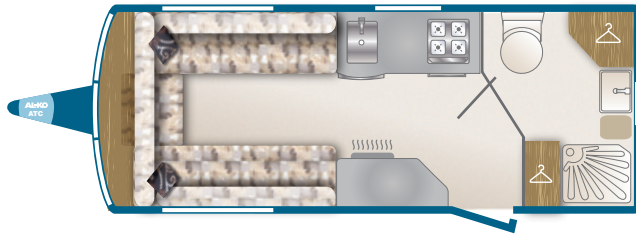

**460-2** 2 Berth

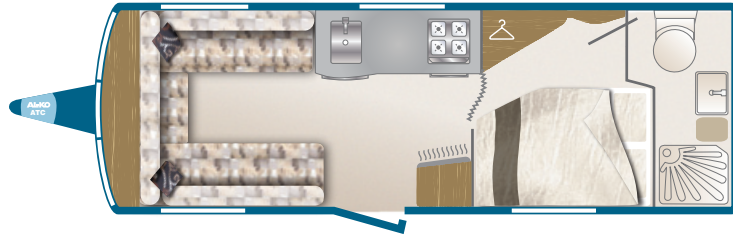

**530-4** 4 Berth

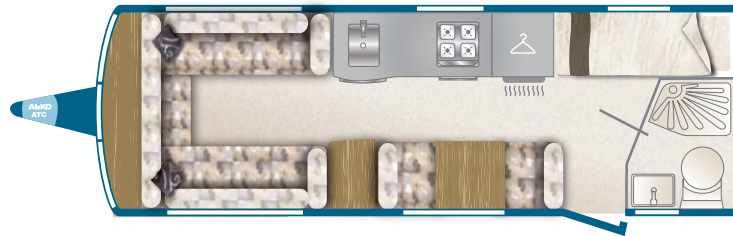

**540-5** 5 Berth

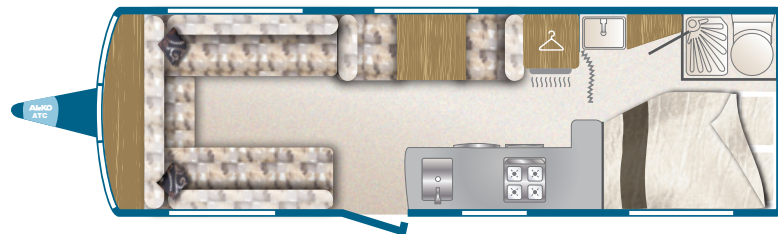

**620-6** 6 Berth  
Twin Axle

	460-2	530-4	540-5	620-6 Twin Axle
Berths	2	4	5	6
Internal Length	4.902m / 16'1"	5.678m / 18'8"	5.678m / 18'8"	6.292m / 20'8"
Shipping Length	6.475m / 21'3"	7.251m / 23'9"	7.251m / 23'9"	7.865m / 25'10"
Overall Width	2.19m / 7'2"	2.19m / 7'2"	2.19m / 7'2"	2.19m / 7'2"
Overall Height	2.63m / 8'8"	2.63m / 8'8"	2.63m / 8'8"	2.63m / 8'8"
Internal Headroom	1.96m / 6'5"	1.96m / 6'5"	1.96m / 6'5"	1.96m / 6'5"
Awning Size	968cm	1046cm	1046cm	1113cm
Tyre Sizes	195/70 R14 LI96N	185/R14 LI104N	185/R14 LI104N	185/R14 LI93N
MTPLM	1276kg / 25.1cwt	1443kg / 28.4cwt	1450kg / 28.5cwt	1649kg / 32.5cwt
MRO	1135kg / 22.3cwt	1275kg / 25.1cwt	1272kg / 25.0cwt	1454kg / 28.6cwt
Optional Equipment Payload Allowance	15kg / 0.3cwt	15kg / 0.3cwt	15kg / 0.3cwt	15kg / 0.3cwt
Total User Payload	141kg / 2.8cwt	168kg / 3.3cwt	178kg / 3.5cwt	195kg / 3.8cwt
Front Double	6'6" x 6'3"	6'6" x 5'3"	6'6" x 5'7"	6'6" x 5'11"
Front N/S Single	6'3" x 2'3"	5'6" x 2'3"	5'7" x 2'3"	5'11" x 2'3"
Front O/S Single	6'3" x 2'3"	5'3" x 2'3"	5'7" x 2'3"	5'11" x 2'3"
N/S Single	-	-	5'7" x 2'6"	-
O/S Single	-	-	-	5'7 x 2'3"
O/S Overhead Single	-	-	-	5'5" x 2'0"
Rear Fixed Bunks	-	-	6'3" x 2'1" (x2)	-
Rear Fixed Double	-	6'4" x 4'6"	-	6'4" x 4'6"

The method of calculating the MRO and payload figures has been changed for the 2011 model year. Allowances for essential equipment previously accounted for in the user payload are now either within the MRO (e.g. gas cylinders) or the personal effects payload allowance (e.g. leisure battery).



Branded Radio/CD/MP3 player with iPod connectivity (iPod & cable not included)



Spacious overhead storage lockers



Thetford 107 litre refrigerator with full width freezer compartment



Stainless steel 800 watt microwave



Gloss laminate kitchen worktop

360 degree product tours for all layouts can be viewed on the Olympus microsite: [www.baileyolympus-s2.co.uk](http://www.baileyolympus-s2.co.uk)



Olympus 460-2



Olympus 620-6 (Bed linen available as a cost option)



Optional chest of drawers unit with slide out occasional table

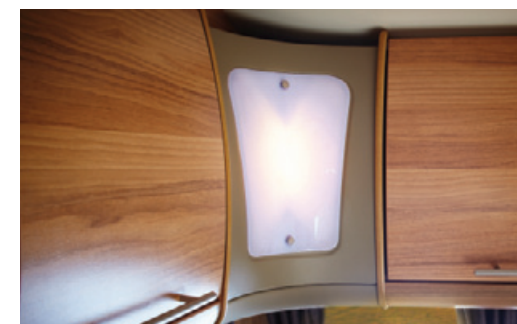

Flush fit 12v corner lights





**www.baileyofbristol.co.uk**

South Liberty Lane, Bristol BS3 2SS, England

This brochure does not constitute an offer by Bailey Caravans Ltd (Bailey). Bailey reserves the right to alter specifications and prices as market and supply conditions demand. Your Bailey retailer will confirm all specification details prior to you making your purchasing decision. E. & O. E. Bailey retailers sell our products of their own choice and not as agents of Bailey. Accordingly they have no authority to bind Bailey or to make any representation or undertaking whatsoever on behalf of Bailey. All household items illustrated in this brochure are used to enhance photography and are for display purposes only. They are not supplied with your touring caravan. Photographic colour reproduction is subject to the limitations of the production process.

Design & Print: Kingsdown Photography: Alan Bond Issued: February 2013



80% Recycled paper



NATIONAL CARAVAN  
COUNCIL LIMITED

All Bailey models have been certified by the National Caravan Council for compliance with stringent European Standards, British Legislation and industry set Codes of Practice specifically relating to health and safety issues. NCC Approval gives you peace of mind that your caravan is safe and legal

**Olympus**  
Alu-Tech Bodysell

*Lightening the load*



*Olympus 540-5 (Bed linen available as a cost option)*